

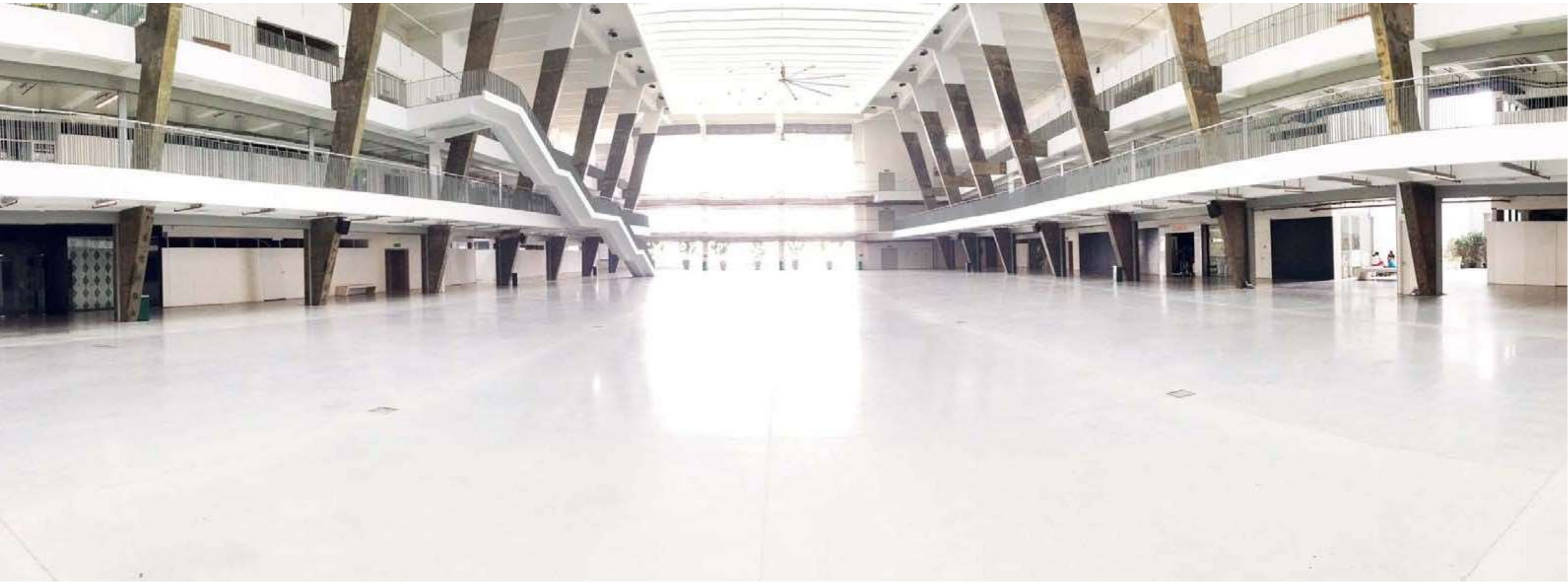

SALES KIT



ABOUT KWC FASHION WHOLESALE

- Malaysia's first fashion wholesale and retail shopping mall.
- Located in the heart of Kuala Lumpur, opened in 2011 and are few minutes from the city's Golden Triangle.
- Houses more than 800 wholesale and retail shops.
- Selling a range of fashion-related merchandise including women's, men's and children's apparel, accessories, shoes and leather goods.
- Easily accessible by car and public transportation.



ABOUT STARXPO CENTRE

- 32,065 sq. ft. purposed built covered hall at Level 15 of KWC Fashion Mall.
- Hosted several concerts and events including Sheila on 7 Live in Kuala Lumpur, Malaysia and more.

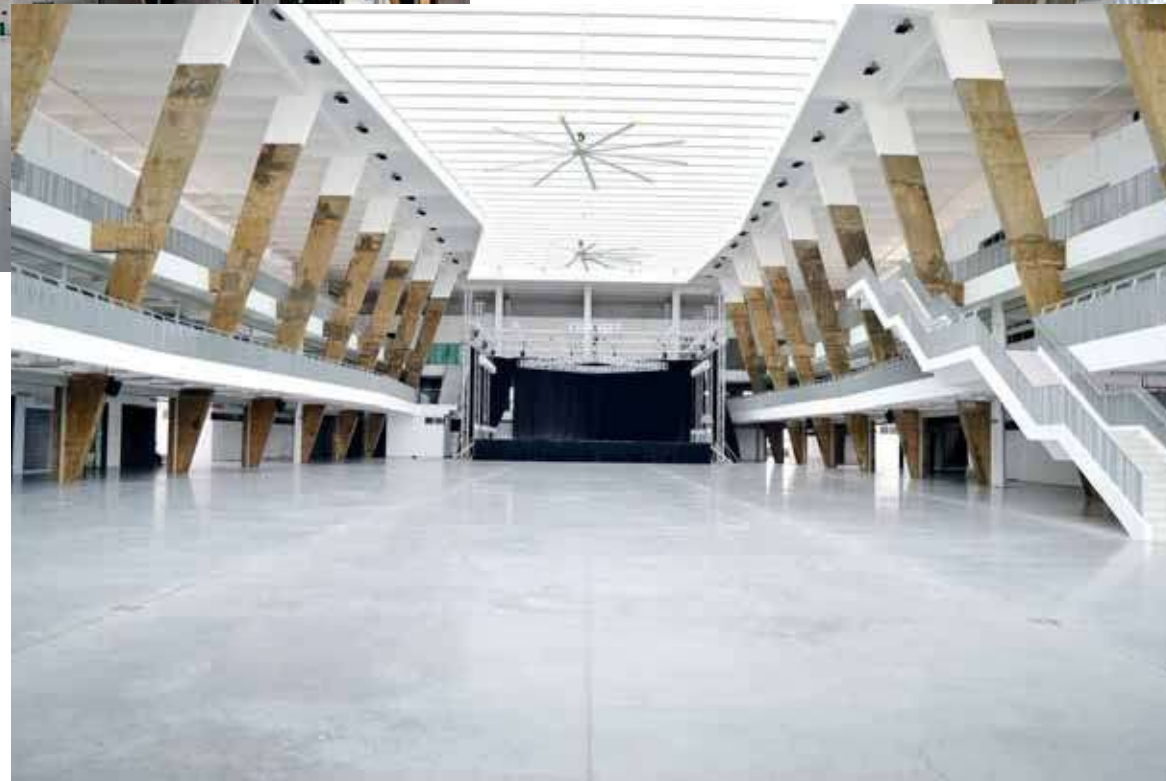
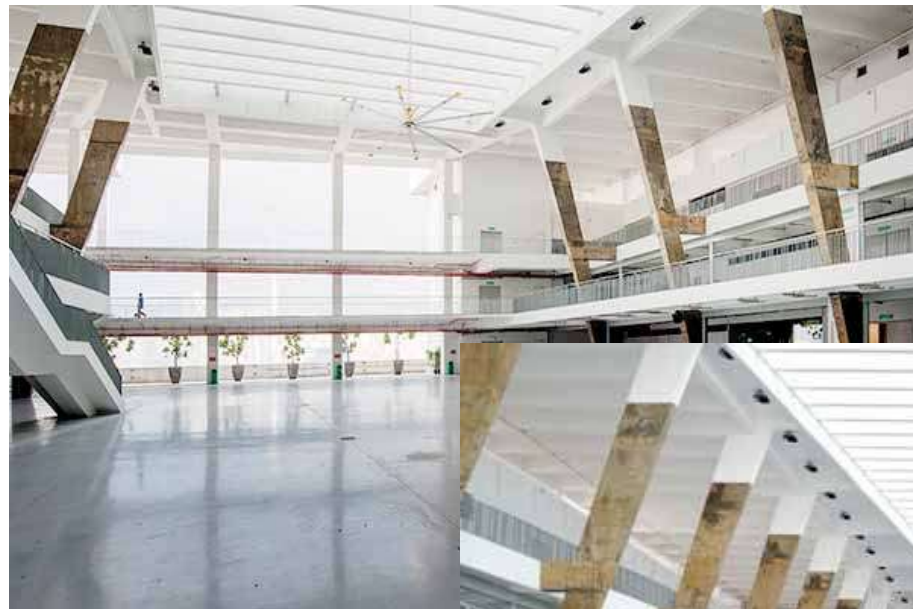

TECHNICAL SPECIFICATION

	Level 15	Level 16
FloorDimensions (LxW)	89.2 m x 33.4m	Irregular
Gross FloorArea	2,979m ² (32,065 ft ²)	961 m ² (10,344 ft ²)
Ceiling Height	16 m (54ft)	3.24 m (11 ft)
Roller Shutter	26 units to atrium	27 units
Column-free	Yes	No

Atmosphere:	Open air with 4 BIGASS ceiling fans
Lighting:	40 nos. of 1,000 watts floodlights
Floor loading:	Live load 5 kN/m ² (100 lb/ft ²)
Flooring:	Cement screed finish
Water supply:	Available
Stage type:	Stage truss system
Stage size (LxWxH):	17.07 m x 14.63 m x 1.68 m
Stage rigging size (L x W x H):	19.54 m x 14.38 m x 12.60 m
AV room (m ²):	4 m x 4 m (16 m ²)
	2 nos. 400A 3 phase isolators
	1 nos. 200A 3 phase isolators
Hospitality lounge (area):	4 VIP rooms (Section A & B)
	1 Storeroom
	3 toilets



Flooring lounge:	Tiles
Hall toilets (Male/female):	2 male / 2 female
Hall toilet (Disabled):	1 unit
Lift access:	11 Passenger lift & 1 Freight lift
Passenger lift capacity:	29 people / 1,975 kg
Freight lift capacity:	5 tonnes with 8ft height
Freight lift door opening:	2.4 m x 2.4 m
Loading freight door (W x H):	1.8 m x 2.1 m
Loading dock bays:	8 Trucks (3 tonnes and below) / 1 Truck (40 foot container)
CCTV:	Available
Mall parking bay:	1,525 lots

ADDED FACILITIES

BANQUET CHAIRS
(3500)



Black



Blue



Red

Oblong Banquet Tables

Big (2.5ft x 6ft): 36
Small (1.5ft x 6ft): 11



Q-Pole (72)



F&B Cart (8)
4.8ft (w) x 2.5ft (h)



Mobile Stage (6)
6ft x 8ft H2.6ft



Barricades (59)



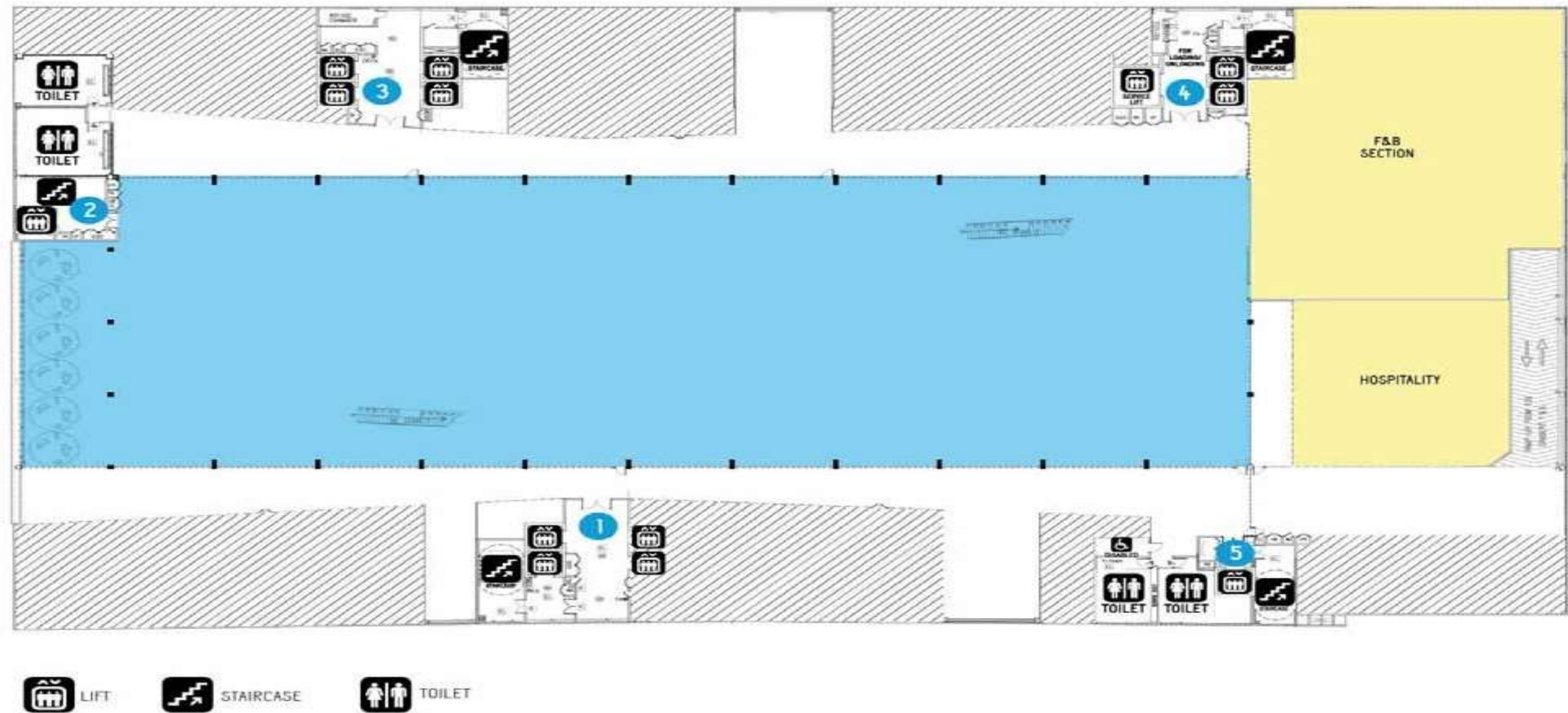

STARXPO Centre	Gross Area ft ² / m ²	Setup Arrangement / Capacity			
		Theatre	Banquet	Classroom	Booth (3Mx3M)
Level 15	32,065 / 2,979	3,500	60	1,000	100

PAST EVENTS 2019



STRIDER CUP MALAYSIA 2019 @
STARXPO CENTRE
(SERIES 01)



Retro Rahman 2.0



TIAN KONG
MUSIC FESTIVAL



PAST EVENTS 2018



SHEILA ON 7 LIVE IN KUALA LUMPUR



EID UTSHOB with LRB

PAST EVENTS 2017



MAXIS
CONFERENCE



SCORE FIT MOB
2017

PAST EVENTS 2016



Standard Chartered KL
Marathon 2016 Race
Entry Pack Collection

GLOBAL ART-
NATIONAL ART
COMPETITION 2016



A red and white train with a large mural on its side, traveling on an elevated track. The mural depicts a traditional Indian scene with figures and a horse. The train is moving towards the left.

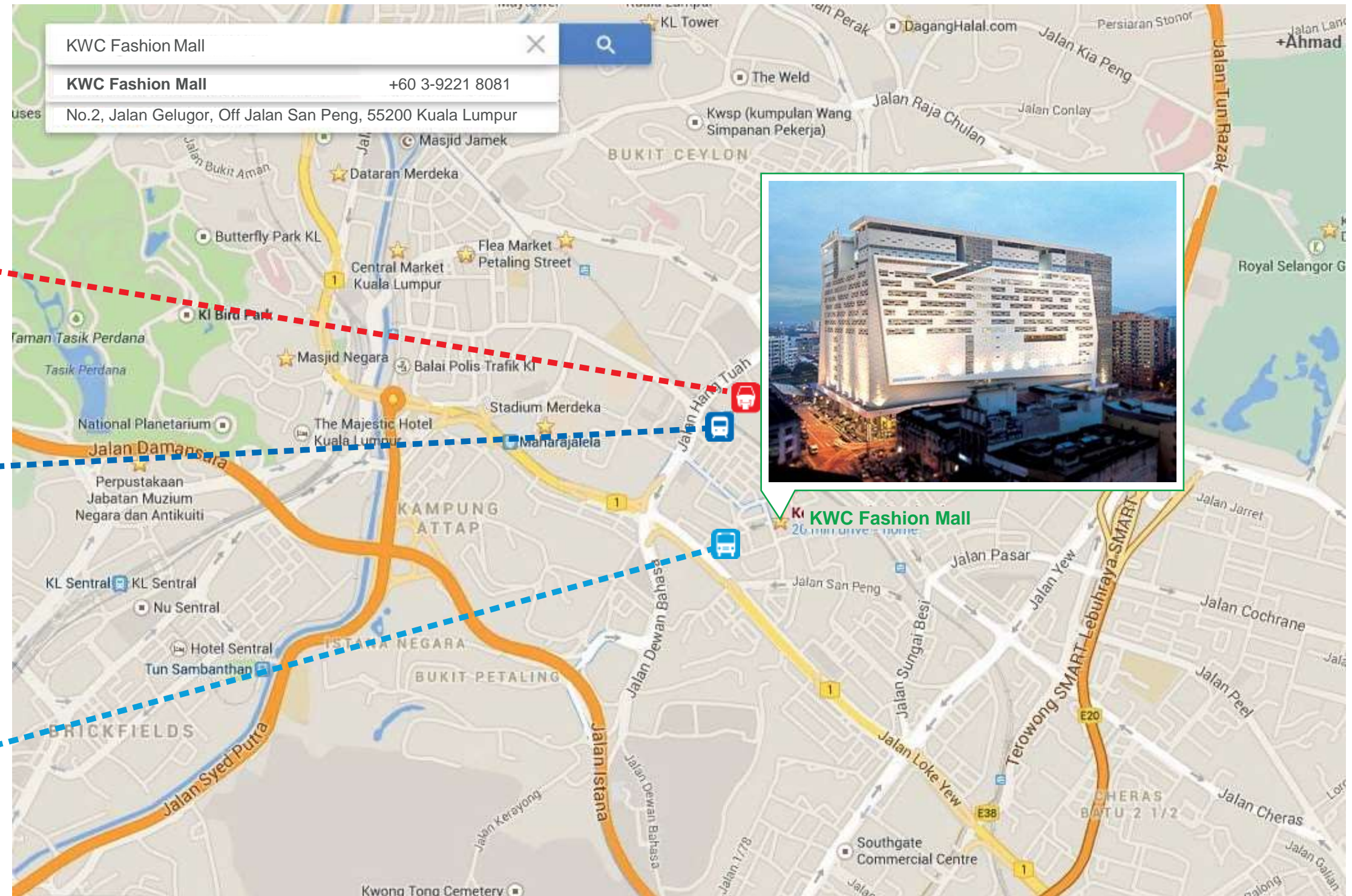

CONTACT US

For more information, please contact:

WENDY LAM

Manager Advertising and Promotion Department

T: +603 9221 8081 ext 8501

F: + 603 92218082

M:+6016–8843198

DINA ALYA BINTI JONAI

Jr. Executive Advertising and Promotion Department

T: +603 9221 8081 / 8086 ext 8404

F: + 603 92218082

M:+6014 – 7194693

KWC FASHION WHOLESALE

.01, Kompleks Kenanga Wholesale City, No. 2, Jalan Gelugor,
55200 Kuala Lumpur

